

LIGHT HOUSE

Light House is a double-sided movie pavilion on Jericho Beach. Repeating glulam frames are strengthened with steel cables, forming a luminous open-air beacon in the seaside landscape.

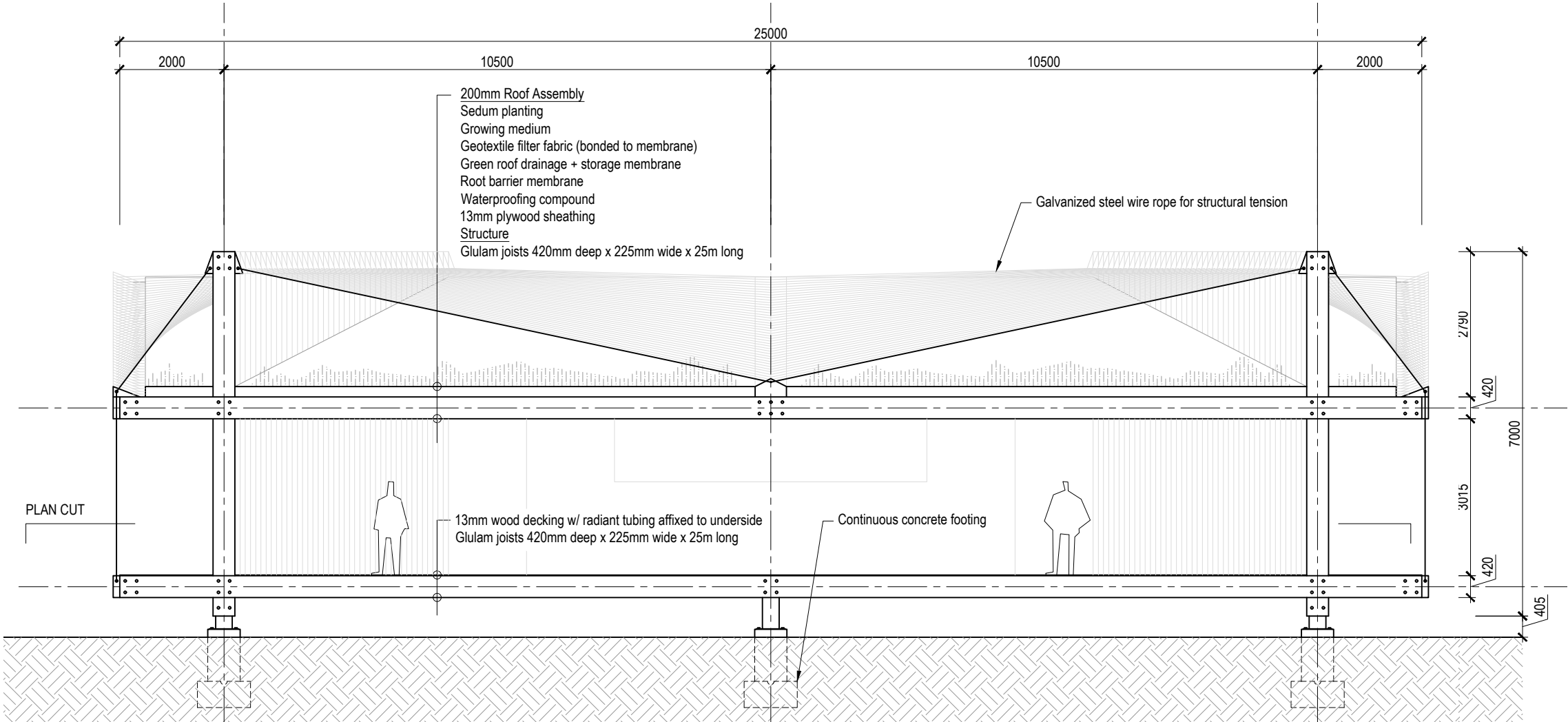

EXTERIOR VIEW OF ENTRY



ELEVATION AT ENTRANCE 1:100



EXTERIOR VIEW
Looking northwest

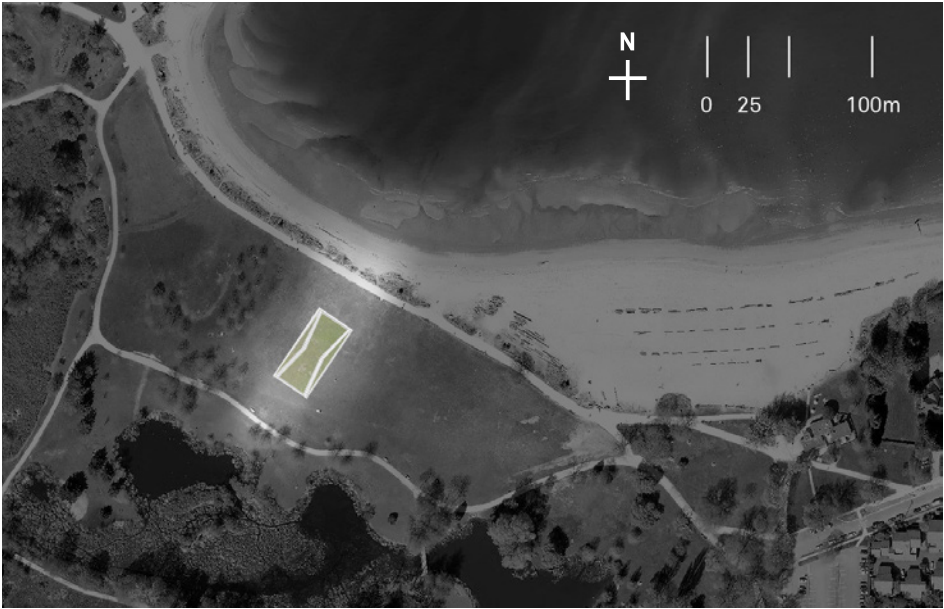

SITE PLAN
Pavilion oriented perpendicular to water's edge

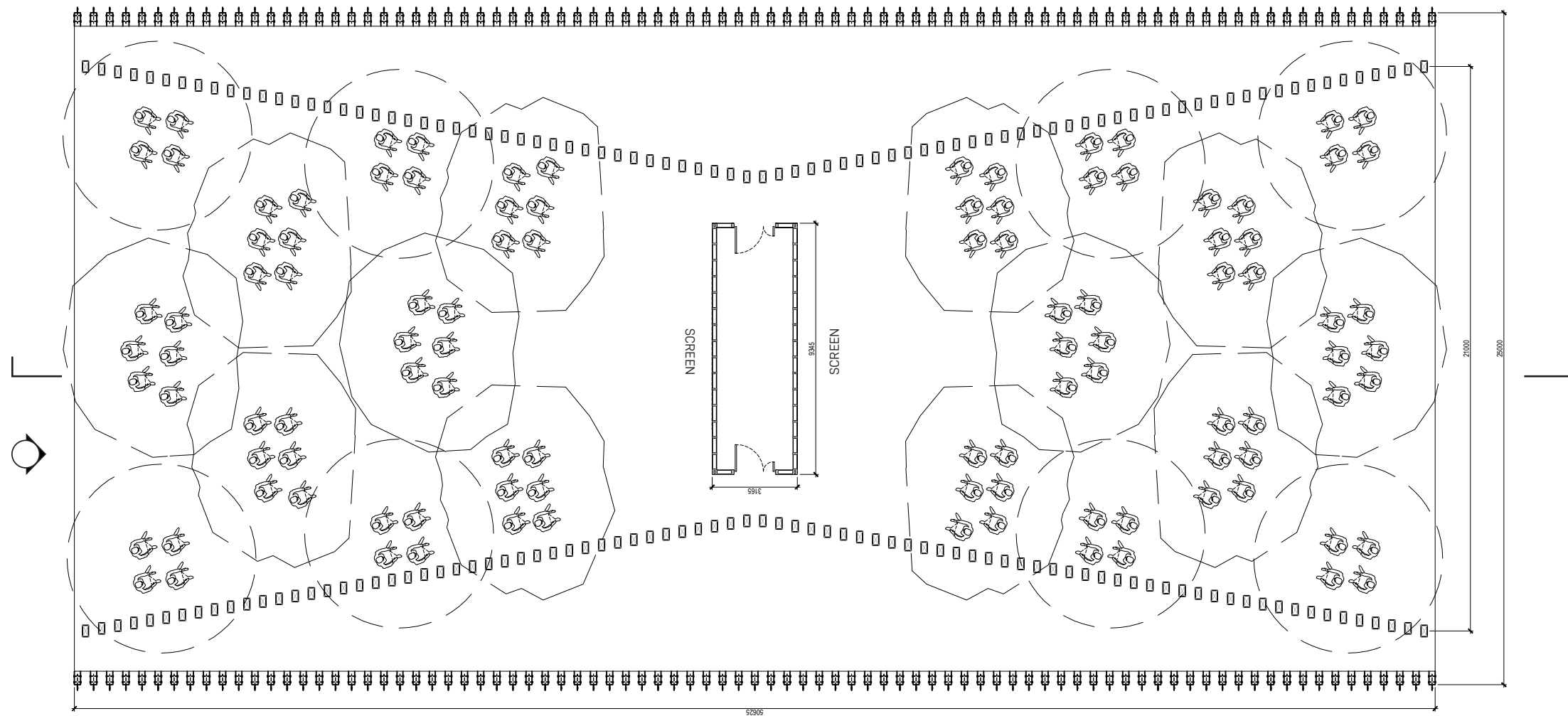

PLAN 1:200

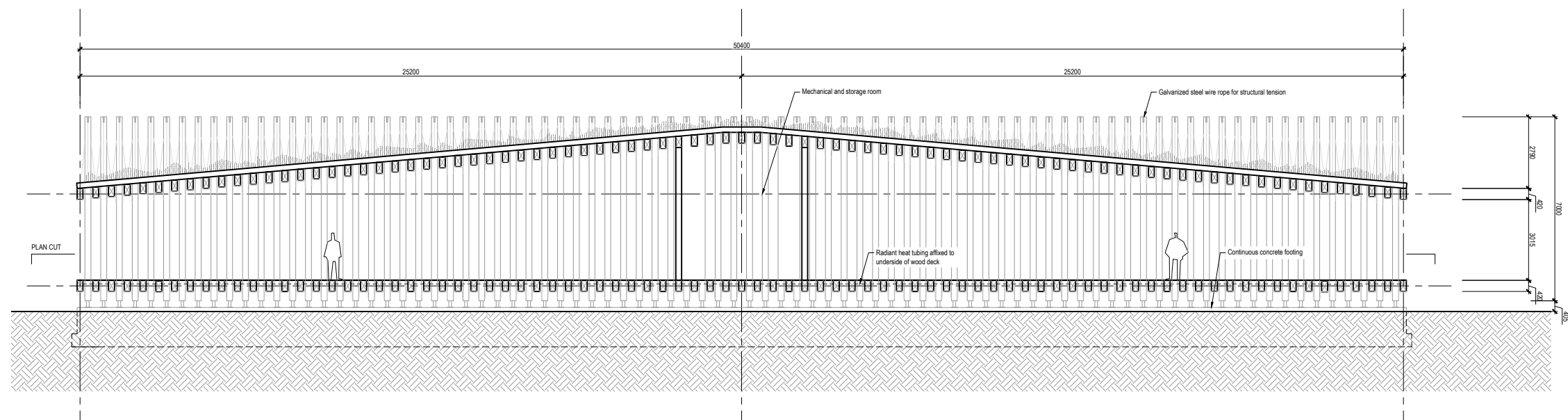

LONGITUDINAL SECTION 1:200

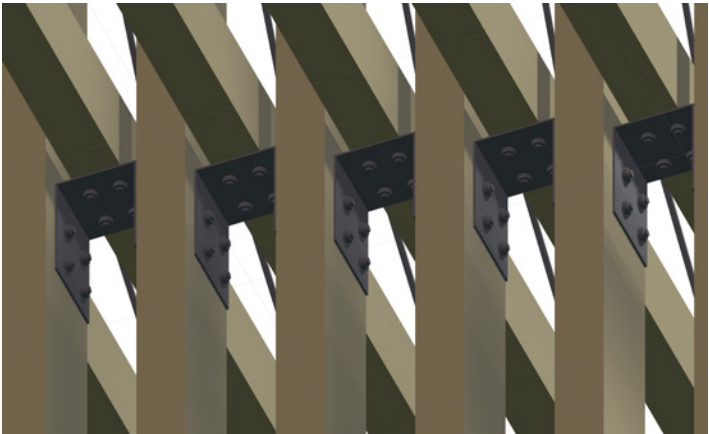

BEAM-TO-COLUMN CONNECTION
Bottom-up isometric view

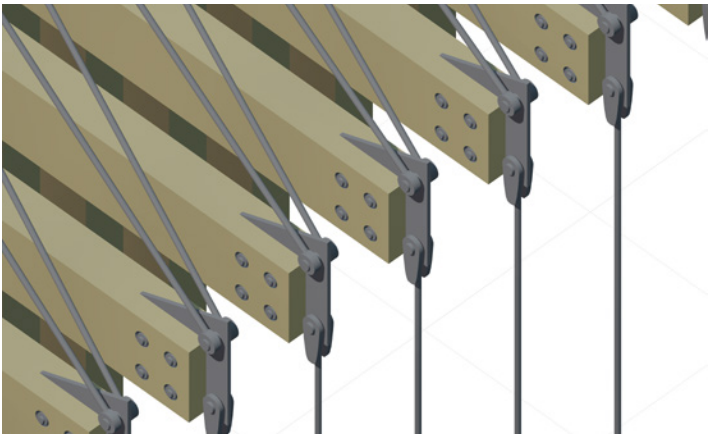

END-OF-BEAM CABLE CONNECTION
Top-down isometric view

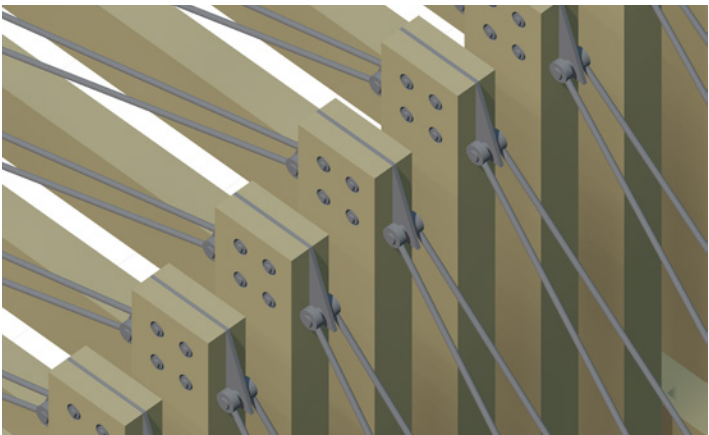

TOP-OF-COLUMN CABLE CONNECTION
Top-down isometric view